

1. Open GO-Global in your browser.
2. Use the Restore Down button to minimize the window so that it only covers a portion of your desktop.

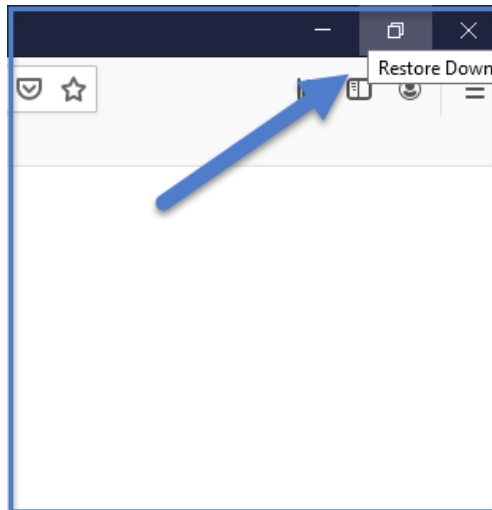

3. Find the padlock icon next to the webpage address.

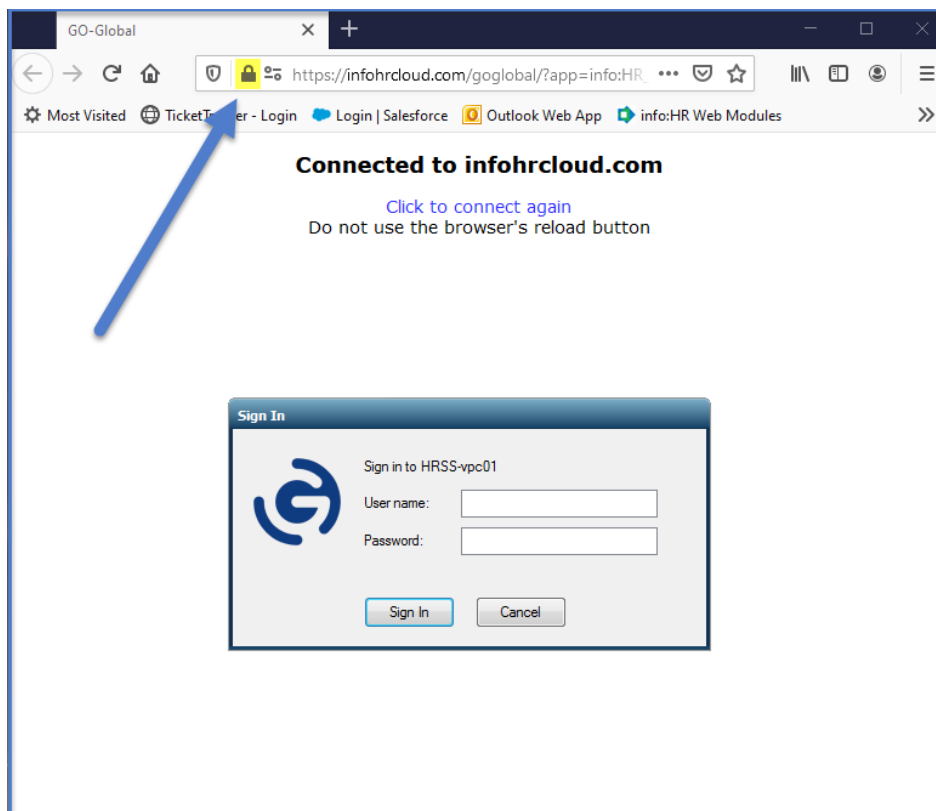

4. Drag the padlock to an empty space on your desktop.

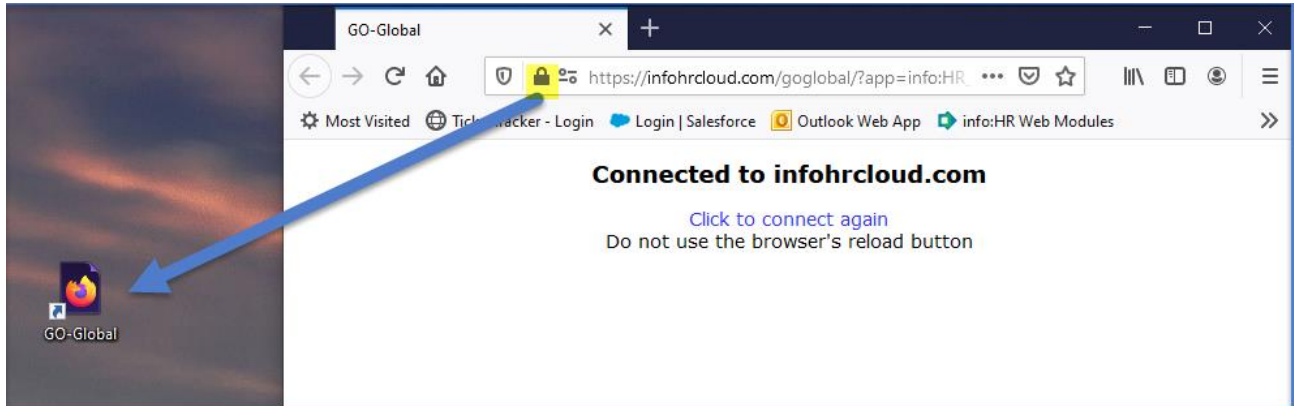

Finally, you will see a GO-Global shortcut icon on your desktop. Click the icon to ensure it opens to the GO-Global login page and sign in.